



10 Birchwood Road, Bristol, BS4 4QH

£1,250 Per Month

PLEASE EMAIL YOUR INTEREST

This three-bedroom first floor beauty is what you've been waiting for. Perfect for a small family or couple (sorry no sharers).

Everything about this place screams space, from the hallways to the kitchen there is nothing small about this property .

The master bedroom is no exception, situated in what was the loft you couldn't ask for a lighter, brighter place to lay your head, there's even a hidden side space just crying out to be made into a walk-in wardrobe.

With a Post Office, local shop, takeaway and hairdressers, literally on your doorstep and the brilliant Sandy Park Road conveniences , bars and delis only a 15-minute stroll away , this really is the perfect pad.

Floor Plan

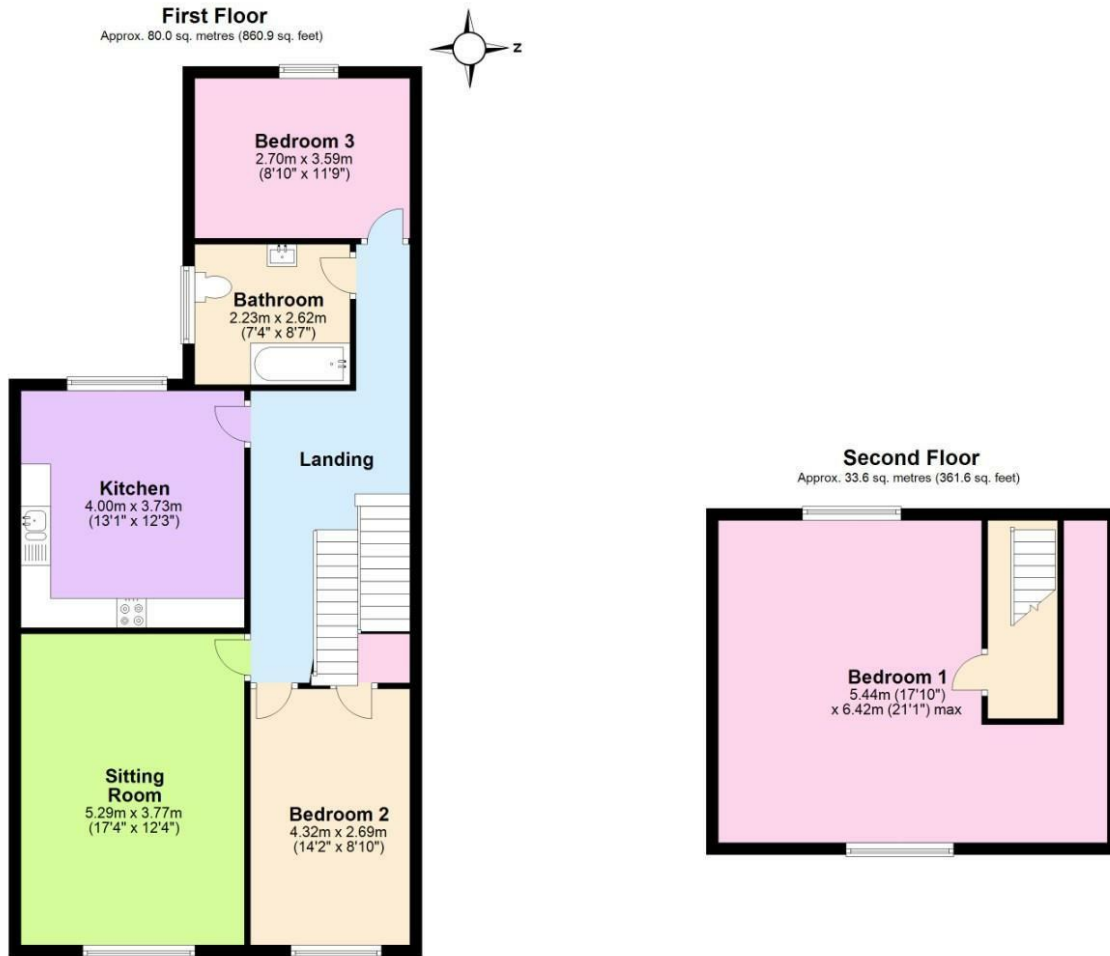

Total area: approx. 113.6 sq. metres (1222.5 sq. feet)
TFF 10 Birchwood rd, Bristol

Area Map

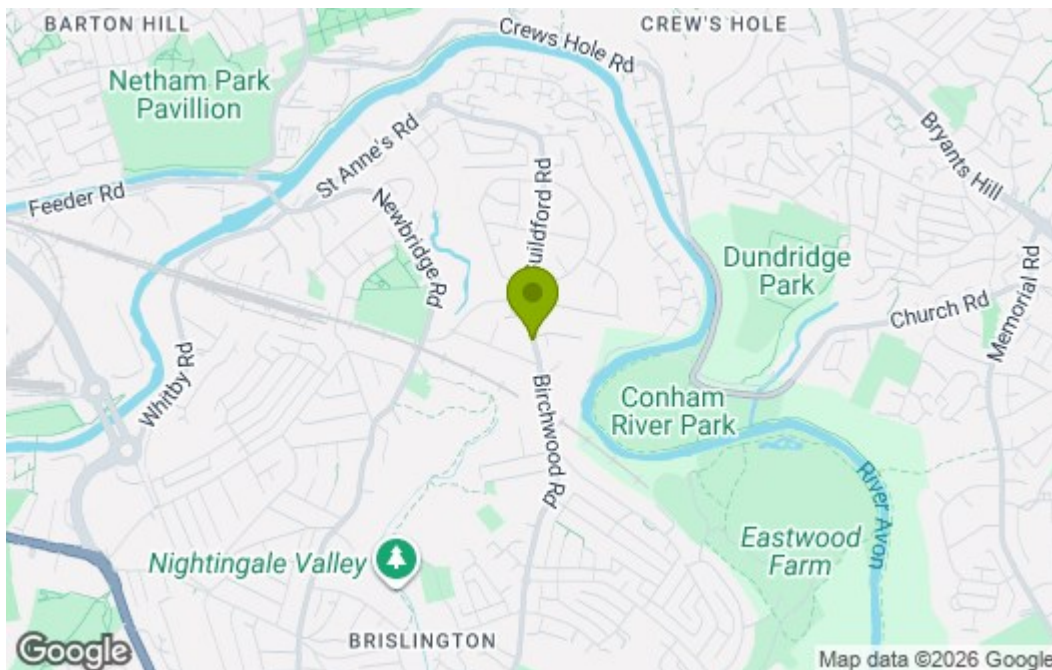

Energy Efficiency Graph

Energy Efficiency Rating		Current	Potential
Vary energy efficient - lower running costs			
(92 plus) A			
(81-91) B			
(69-80) C			
(55-68) D			
(39-54) E			
(21-38) F			
(1-20) G			
Not energy efficient - higher running costs			
England & Wales		EU Directive 2002/91/EC	

These particulars, whilst believed to be accurate are set out as a general outline only for guidance and do not constitute any part of an offer or contract. Intending purchasers should not rely on them as statements of representation of fact, but must satisfy themselves by inspection or otherwise as to their accuracy. No person in this firm's employment has the authority to make or give any representation or warranty in respect of the property.